



RGB-38, Staging Gas Burner

Specifications

- One stage burner with capacity of 154-500 kW on gas side (15.4-50 Nm³/h for G20), and turn down ratio of 1:3, and NOx class II.
- Compatible with all types of combustion chambers according to EN-303 or BS-EN 12953-3 standards.
- Suitable for firetube, firebox and water tube boilers.
- Burner includes: aluminum housing, flame cover, electrical wiring, air fan, control panel, ignition devices, valves and all necessary safety devices in the gaseous fuel line.
- Burner controller: HONEYWELL DLG.
Controller includes: Main controller, actuator.
- Gas train includes: filter, regulator, main and safety valve, pressure gauges, minimum and pressure switch (according to BS-EN 676).
Gas train is provided in two types depends on the applications:
 - Rp1 ¼ multi-block low-pressure gas train (inlet pressure of 28-360 mbar).
 - Rp2 separate low-pressure gas train (inlet pressure of 12-360 mbar).
- Advantages: Optimal design, high modulating ratio, silent operation and easy installation and maintenance.
- Optional ability: LPG fuel compatibility with LPG nozzle kits.



More information

- Fan motor: 0.45 kW, 1 Phase, 220 Volt, 50 Hz, 2700 rpm.
- Operating ambient temperature: 5-60°C
- Maximum combustion air temperature: 60°C
- Noise emission level: 75 dB in 1.5-meter distance
- Casing insulation class: IP43
- Net weight: 40 kg
- Packing dimensions (length x width x height): 985 x 710 x 590 mm

Reference conditions: Ambient temperature 20°C - Gas temperature 15°C - Barometric pressure 1013 mbar - Altitude 0 m (according to BS-EN 676)

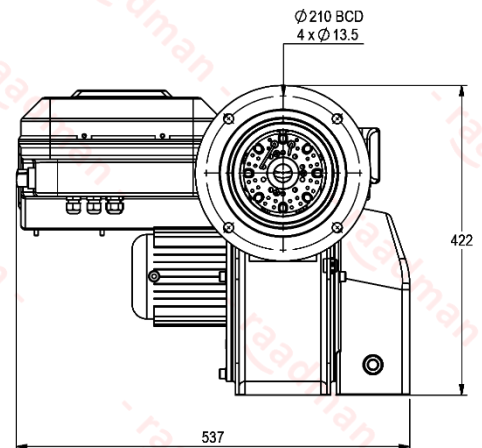
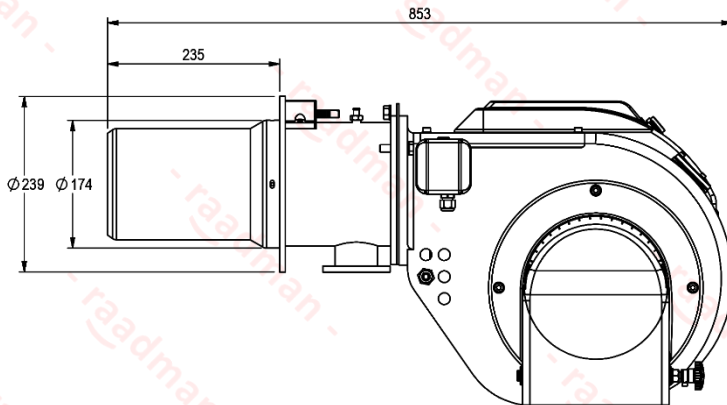
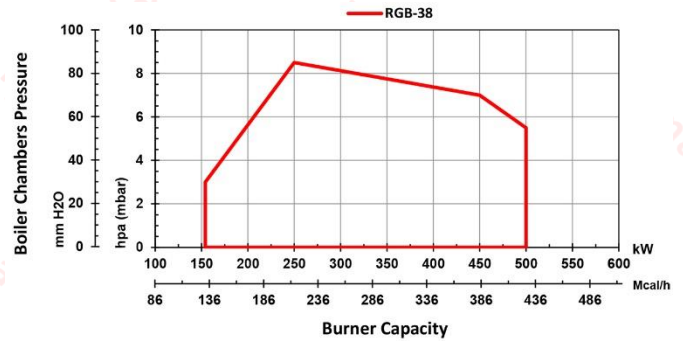

- Suggested boiler flange diameter = 186 mm

Certifications

- Certified in EAEU countries standard No. 0378484.
- Certified in Iran national standard ISIRI-7595 (BS-EN 676).



Scan to access to:
Technical proposal
Technical data
Technical consultation
3D model (only for customers)

